



5000 Series Rotary Stage

An accurate, heavy-duty range of rotary stages which allows precise rotary positioning of objects by stepping or servo motor control. A precision worm and wheel with a 90:1 gear ratio provides repeatable, zero-backlash positioning with high load capacity. A magnetic Datum switch is included. Stepping or servo motor control with a rear-mounted encoder ensures accurate indexing.

All connections are made through a secure QM 19 way connector. A through-hole feature is standard on all Series 5000 rotary stages.



Table Dia	150	250	300
Runout	+/- 0.07mm		
Accuracy	2 arc minutes		
Concentricity	+/- 0.02mm		
Repeatability	20 arcsecs - unidirectional		
Gear Ration	90:1		
Load Capacity kg			
Stage Horizontal	20	95	95
Stage Vertical	9	20	20
Weight (kg)	4	12.5	12.5
Materials	Alumium Alloy and stainless steel		
Finish	Black Anodised		

5000 Series Stage

Dimensional Data

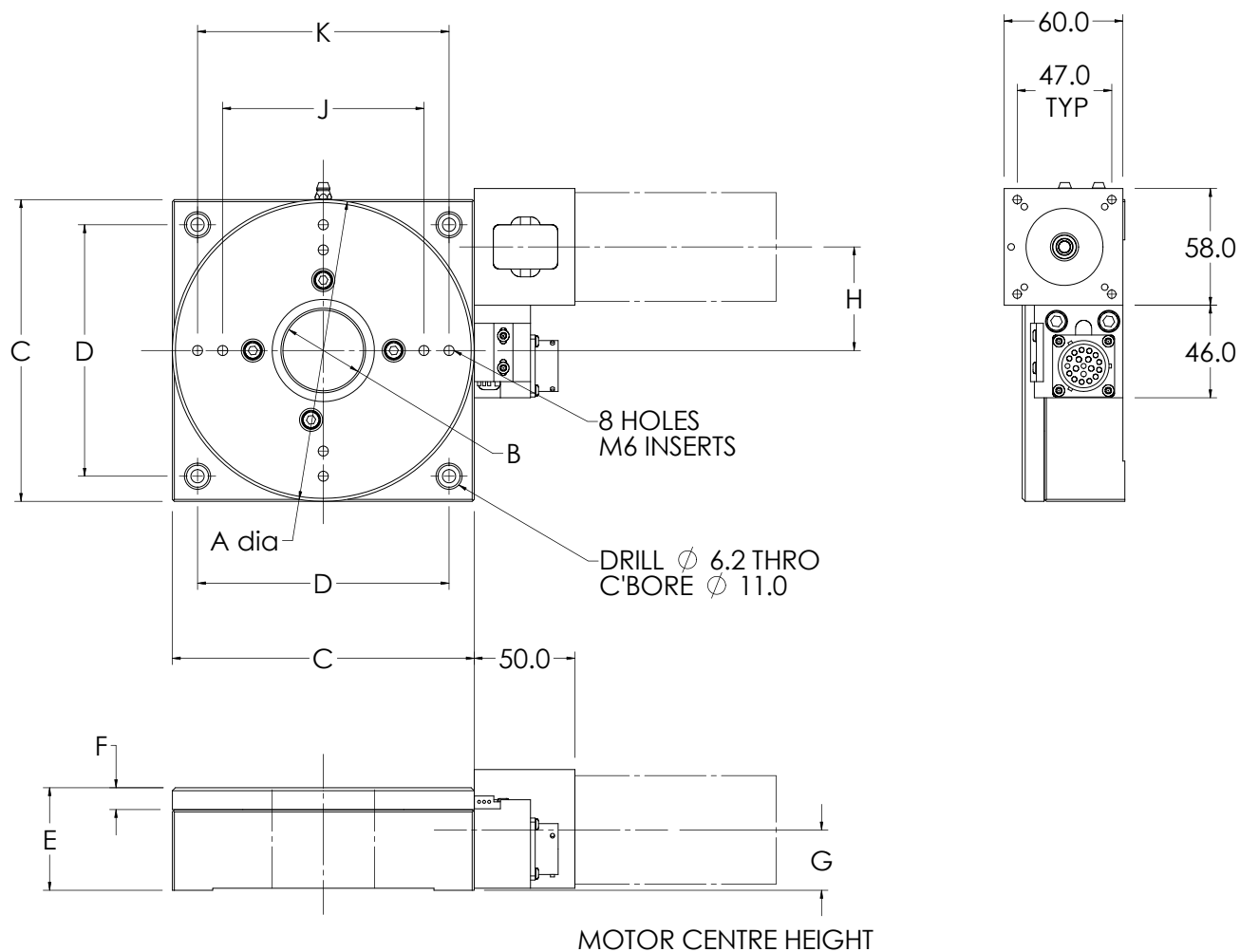

Table Dia Mm	A	B	C	D	E	F	G	H	J	K
150	150	40	150	125	51	10.85	29	59.5	100	125
250	250	70	250	225	75	20	49	84	150	200
300	300	70	250	225	75	20	49	84	200	250